

MEASURE AND CONTROL OF PRESSURE AND TEMPERATURE IN REAL TIME

COMPLETE WIRELESS TPMS KIT - UNIVERSAL & ADAPTABLE

Install a tyre pressure monitoring system (TPMS) in your vehicle



Maintaining proper tyre pressure is vital to passenger safety through:

- reducing of braking distances
- vehicle stability and road handling
- longer tyre life
- greater fuel economy and better ride.

Schrader offers a stand-alone TPMS system for vehicles not OE equipped. It features a dash mounted receiver display and four in-wheel snap-in sensors. The Schrader TPMS system detects tyre under-flation of 25 % or more.

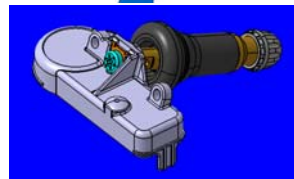
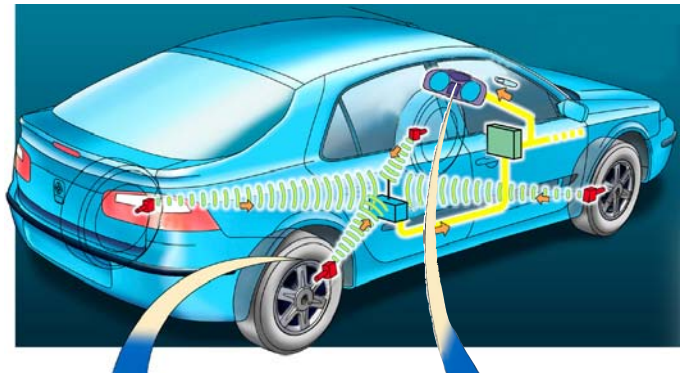

P/N. 65594-67

The kit includes : Dash-mounted receiver/display + 4 wheel-mounted transmitters. Installation instructions.

- Aftermarket system using OE specific and production snap-in sensors.
- system requiring very simple installation.
- Wireless, battery operated (2 AA included).
- Bar, Psi or Kpa and °C or °F : the driver has the choice of selection.
- 4 wheel application.
- Fifth sensor sold separately for spare tyre.
- Re-learning methods very simple to use.
- Hard wiring to switched wires.
- Radio Frequency: 433.92 Mhz.
- Display can be mounted in several places in the car: variable angle fitment.



65649-67

Complete blue sensor (spare part)



Winner of SEMA Awards 2006

Sensors conform to ETSI standards : "European Telecommunications Standards Institute"
RoHS Compliant Directive 2002/95/EC
Waste disposal according to EU Directive 2002/96/EC